

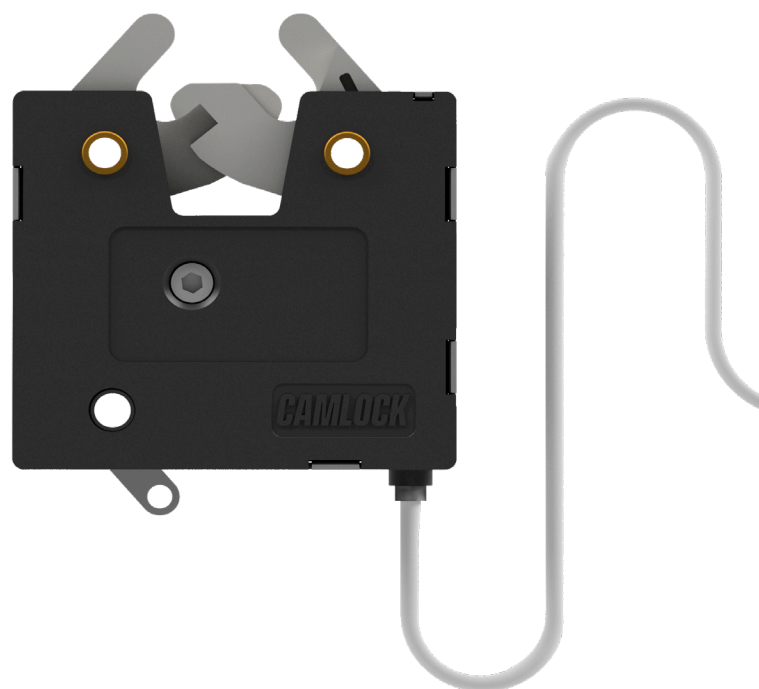

**CAMLOCK**  
SYSTEMS

# SERIES 100

## LATCH INSTALLATION MANUAL



### FUNCTION OF THE LATCH

The compact unit consists of two parts:

- o Part 1 - The Latch, that can be universally mounted
- o Part 2 - The Strike, which is installed onto the door

When the door is closed, the locking bolt of the strike engages the latch and the cabinet is locked. To release the locking element, 12 Vdc is applied to the latch for **six seconds**.

To re-lock, simply close the door and the latch will mechanically engage.

### Wiring details

Please note: The latch is shipped in "installation mode". This means the latch is in the unlocked state. In order to change the latch state, power will need to be applied to the latch terminals as shown in the wiring diagram.

For technical support, please call: +44 (0)1323 410 996

Operating voltage	12 Vdc (+ /- 10%)
Current consumption	0mA Idle 350mA Max
Max. capacity of contact	25v / 0.5A
Jaw holding force	7000 N
Maximum jaw pre-load	350 N @12 Vdc
IP Rating	IP 65
Temperature rating	-20°C to +65°C

Colour	Function
Yellow	Lock position N./C
Blue	Lock position C
Black	Negative 0 Vdc
Red	Positive 12 Vdc

**SMARTER  
LOCKING**





## LATCH DIMENSIONS

### Latch body

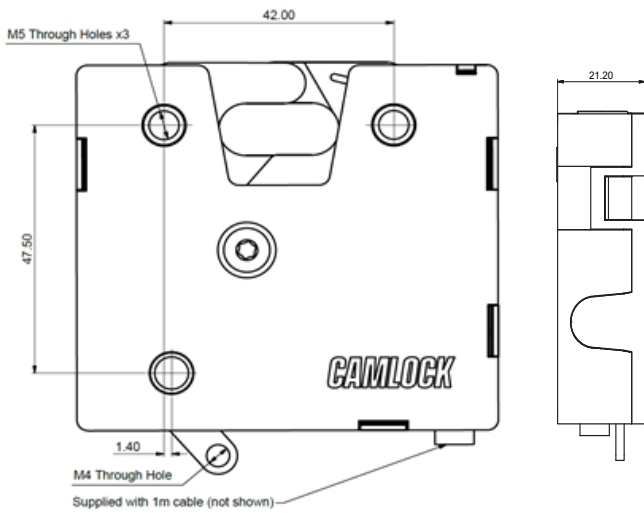

## MOUNTING DRAWINGS

### Locked side view

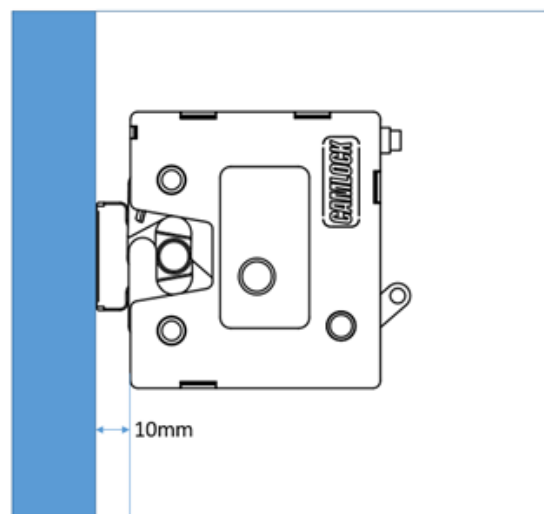

### Latch strike (optional accessory)

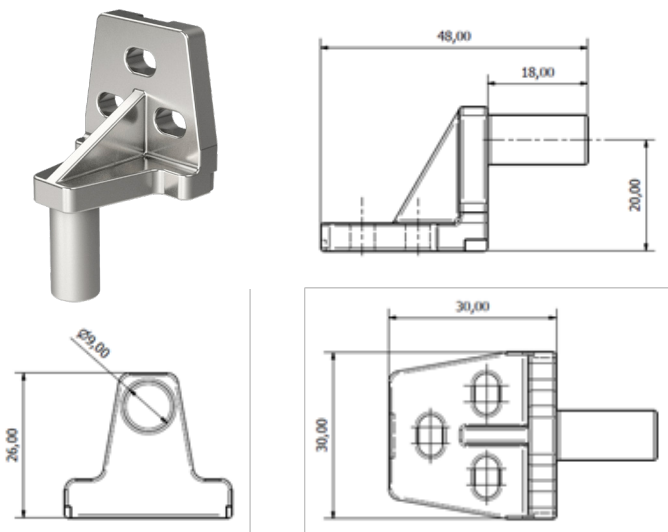

### Locked rear view

