



**CAMLOCK**  
SYSTEMS

**PRODUCT SPECIFICATION**

401 Swing Handle

**401**

**STAINLESS STEEL SWING HANDLE  
WITH A EURO PROFILE LOCKING  
CYLINDER.**



**OVERVIEW**

**Stainless steel handle for outdoor cabinets**

Suitable for a wide range of applications, the 401 is a cam-operated, stainless steel Swing Handle designed to fit double 50mm x 25mm cut-outs. A range of suitable cams in steel, stainless steel and plastic can be ordered in addition to the handle.

**Product features**

- o 316 grade stainless steel
- o Available in a padlockable version
- o Specified with a brass Euro profile cylinder
- o Suitable for a wide range of outdoor applications

**TECHNICAL DATA**

Accreditations	RoHS compliant
Locking cylinder	Brass Euro profile
Measurements	168mm (L) x 38mm (W) x 24mm (D)
Material	Stainless steel
Single or double-skinned cabinet	Single skin
Orientation	Left and right-hand
Fixing hole measurements	Double 50mm x 25mm
Ingress protection	Protective gaskets
IP rating	IP 65
Patented protection	No
Key registration	No

**SMARTER  
LOCKING**



**CAMLOCK**  
SYSTEMS

**PRODUCT SPECIFICATION**

401 Swing Handle

**TECHNICAL DRAWINGS**

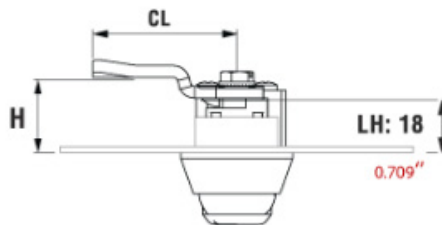
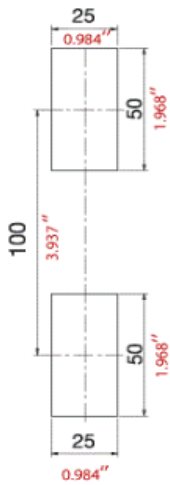
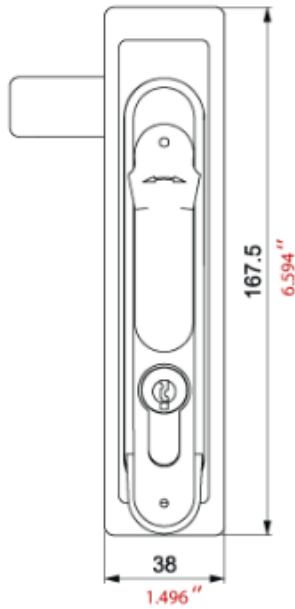
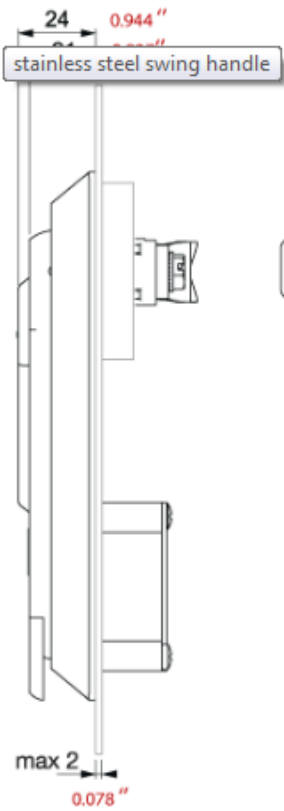

**ADDITIONAL PRODUCT IMAGES**

